

# KERF

## Kerf Wall Installation

[Kerfdesign.com](http://Kerfdesign.com)

# Kerf Wall Hardware

## Hardware Included

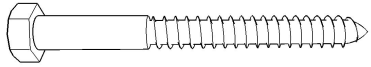

Lag Bolt

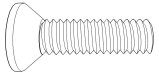

Panel Screw

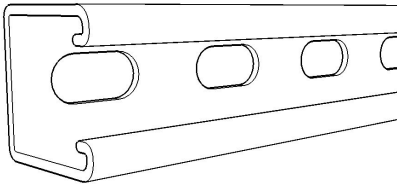

Strut

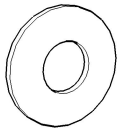

Washer

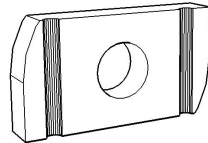

Square Nut



Allen Wrench

## You will need to provide your own:



3/16 Drill Bit

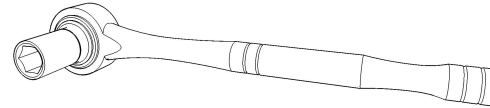

7/16 Socket Wrench

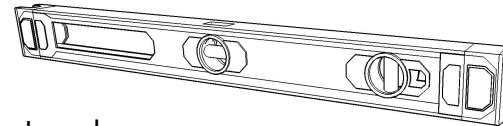

Level

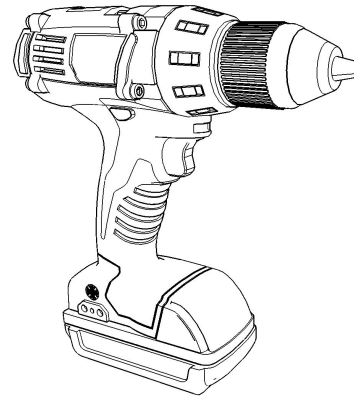

Drill

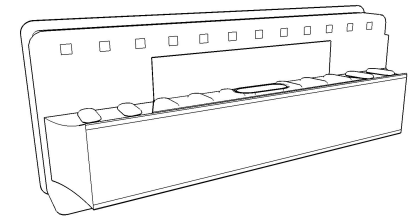

Stud Finder

## Locating the Struts

First, locate your bottom strut on the wall.

- A)** Measure 18.5" from the floor to the bottom of the lowest strut. This sets the bottom edge of the wall panel 12" off the floor. (Use this standard height if you've ordered a desk component.)
- B)** You can choose a custom height for your Kerf Wall Panel.

**Note: Struts are 4" shorter than the width of your finished wall. This allows 2" of overhang at each end of the wall panel.**

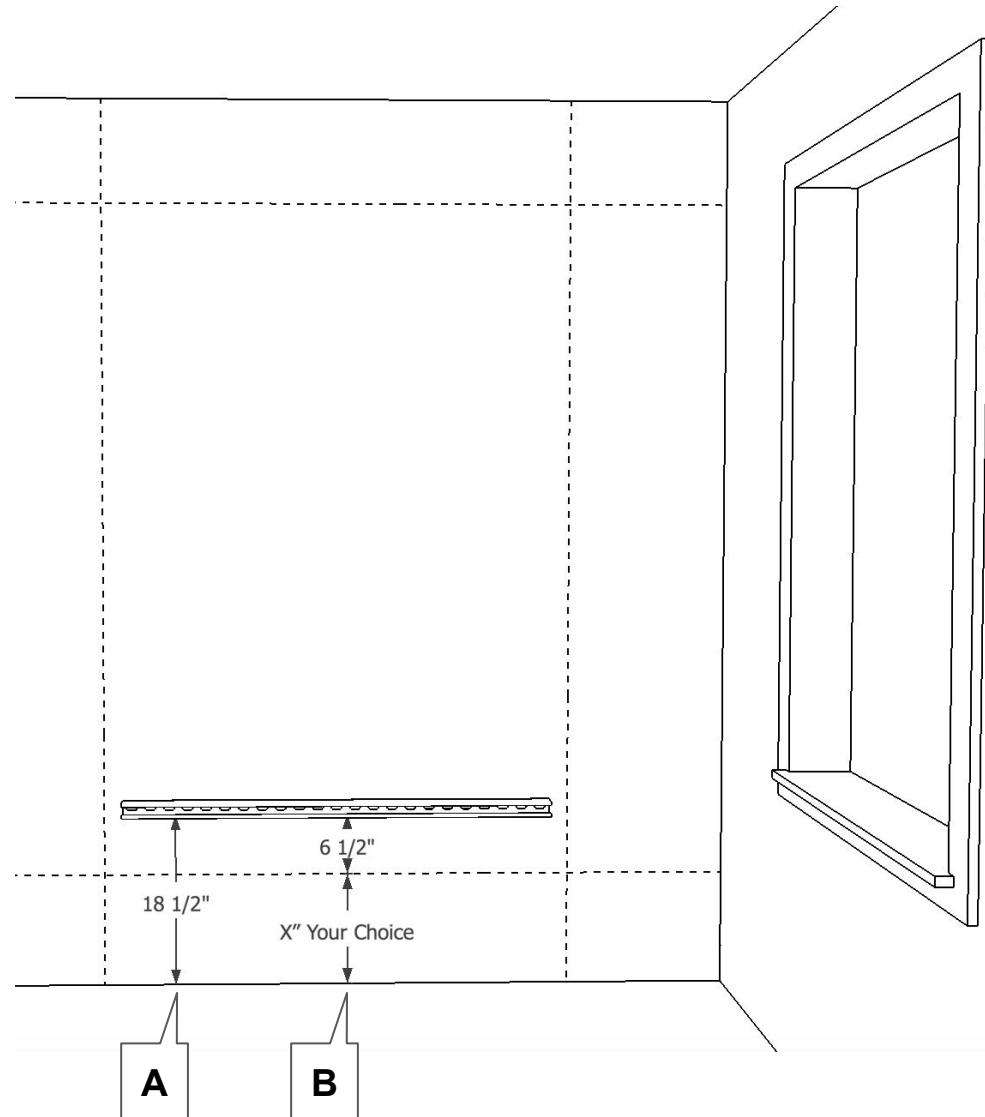

## Attaching the Struts to the Wall

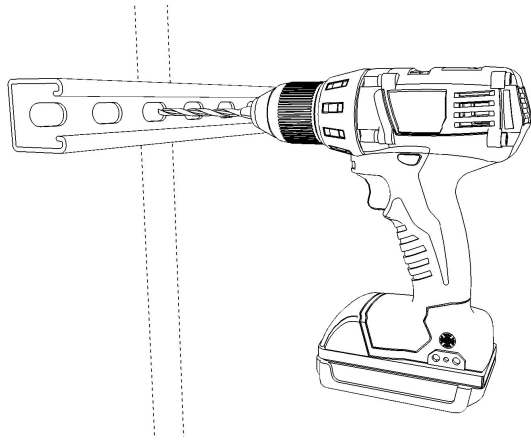

- 1** Find a stud and drill a hole with a 3/16" bit.

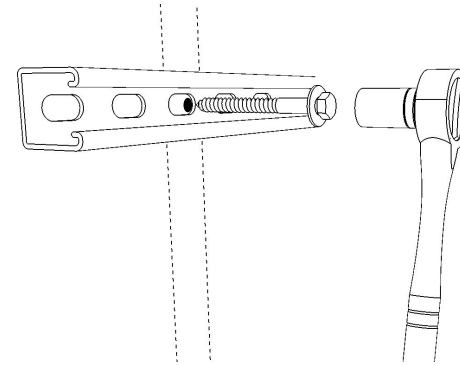

- 2** Use a 7/16" Socket to screw the lag bolt into the stud.

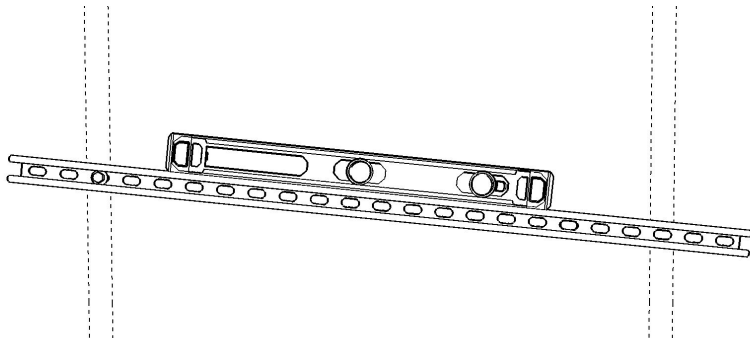

- 3** After you secure one side with a lag bolt, level the strut, and secure the other side into a stud.

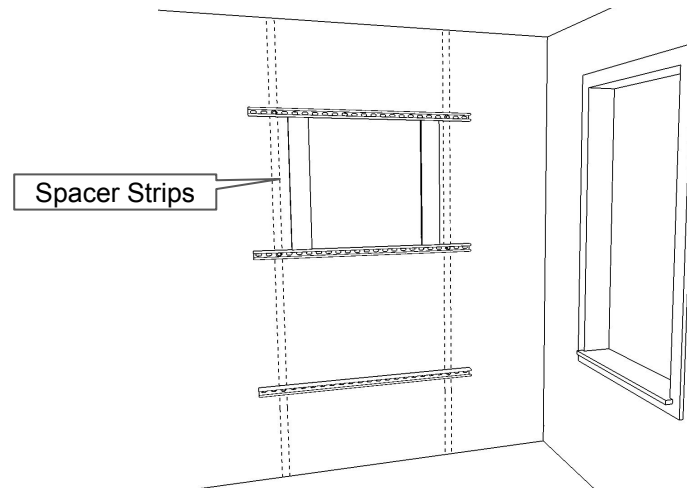

- 4** Use the plywood spacer strips to locate the next strut, check for level, drill pilot holes, and secure with lag bolts. Repeat for third strut.

## Attaching the Panels

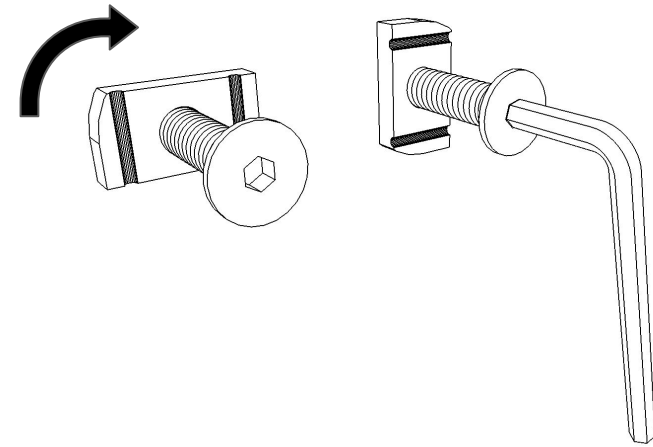
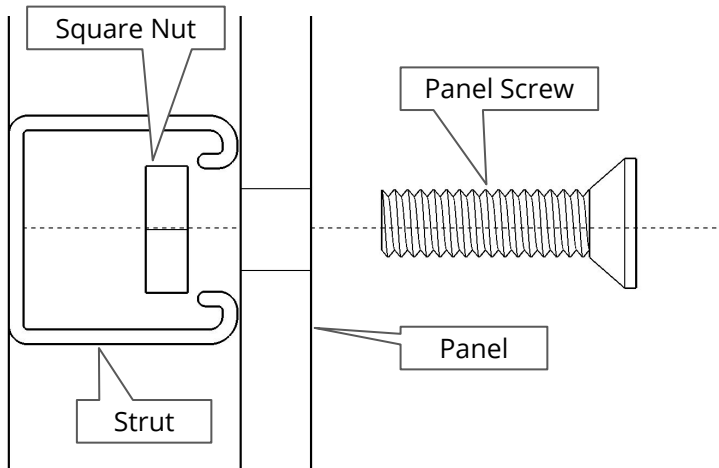

Panel screws go through the Kerf Wall panel and screw into square nuts behind. Square nuts should be horizontal to fit into the strut.

Using the allen wrench, turn the square nuts 90 degrees. Check that the panel is level as you tighten the screws and nuts.

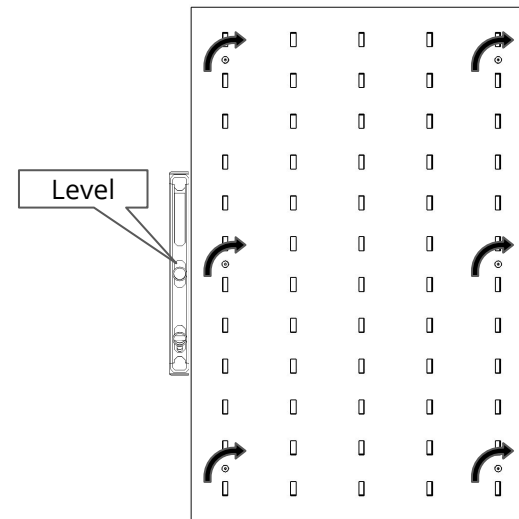
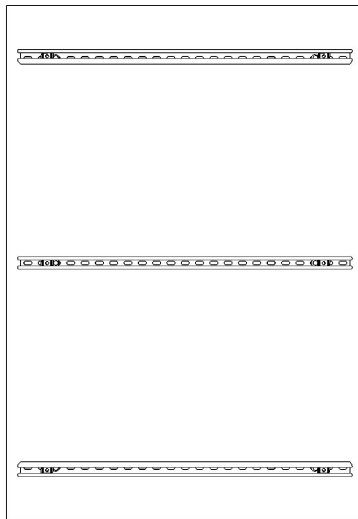

## Arranging Your Components

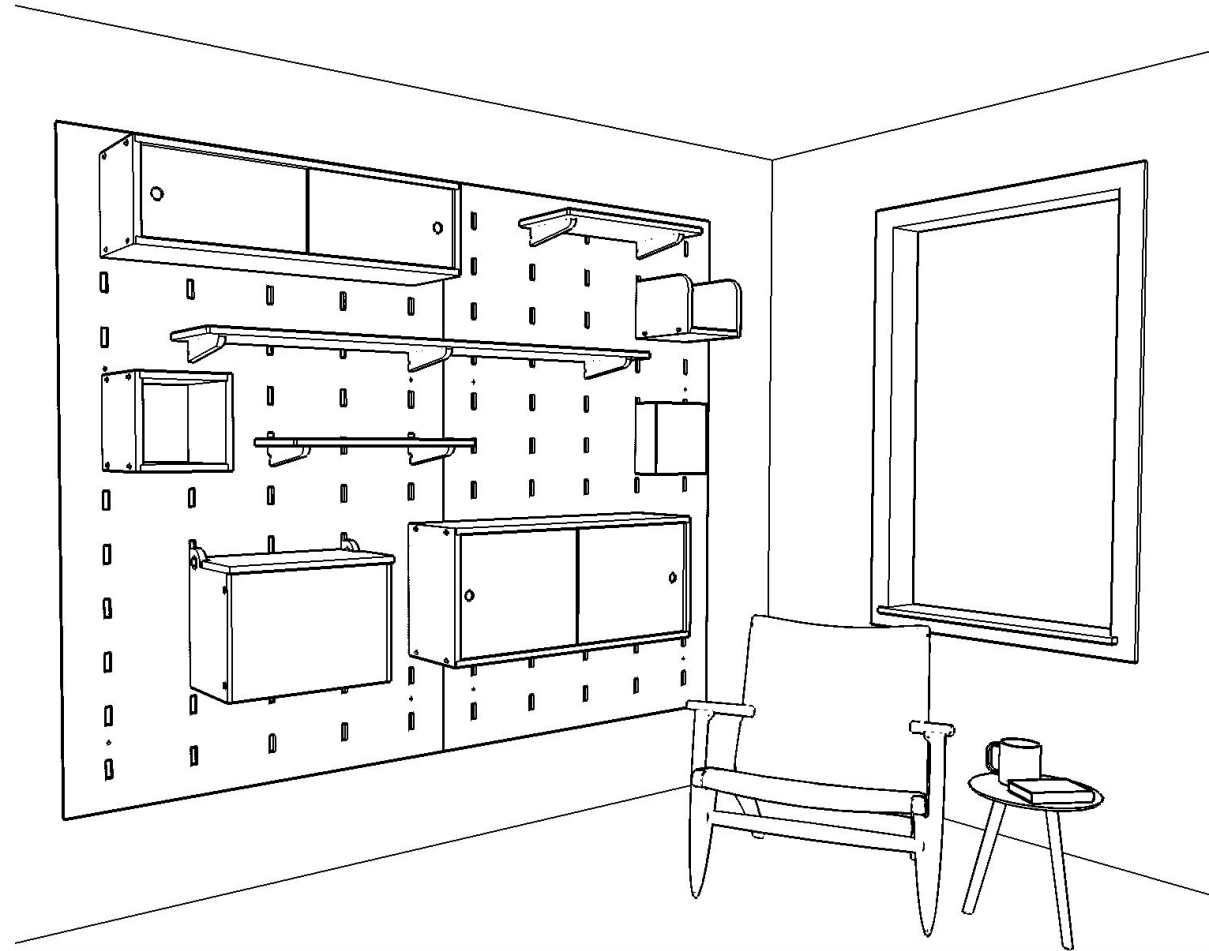

Once the panel is secure and level, arrange your Kerf Wall components however you like!

**If you have any questions, feel free to email us at [hello@kerfdesign.com](mailto:hello@kerfdesign.com) or gives a call at (206) 954-8677. We're here to help!**